



SOVEREIGN INFRA STEELS PVT. LTD.

Structures for Life...

An Industrial Shed / Pre-Engineered Building Manufacturing Company

ABOUT US

Who Are We?

Sovereign Infra Steels Pvt Ltd (SISPL) is a premier manufacturer of Pre-Engineered Buildings (PEB) based in Pune, Maharashtra. Committed to excellence, we provide a diverse range of products designed to meet the evolving demands of PEB infrastructure development. Our focus is on delivering high-quality, durable steel structures that cater to the needs of modern construction projects.

Why Choose Us?

Quality Assurance

At SISPL, we adhere to international standards to ensure that our structures are both durable and reliable.

Customer-Centric Approach

Our team collaborates closely with clients to understand their unique needs, delivering tailored solutions that meet specific project requirements.

Expertise

With years of industry experience, our skilled professionals are equipped to manage projects of any scale and complexity.

At Sovereign Infra Steels, we are passionate about shaping the future of construction. Join us in building innovative, efficient, and sustainable structures that stand the test of time



Our Core Strength

35 Lacks +

Sqft. of Pre Engineered Building Delivered

130 +

Projects Successfully Delivered

1,00,000 Sqft.

Inhouse Manufacturing Facility at Chakan, Pune

40% +

Annual Growth Rate

70+

Highly Skilled & Engineering Professionals

ISO Certification

9001:2015 | 14001:2015 | 45001:2018

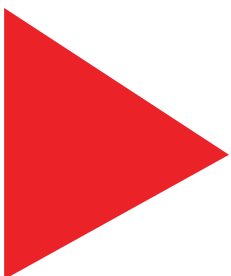



Vision

To become the leading PEB manufacturer company by providing the best Pre-Engineered Building solutions.

Mission

- To increase the production capability of 18 thousand metric tons at the present to 60 thousand metric tons
- To develop and maintain quality, safety and best service facility associated with the pre-engineering building field
- To provide stable as well as functional building solutions on challenging and time-bound projects
- To implement innovated technology in construction and Pre-Engineered Buildings

Values

- EXCELLENCY
- PROMINENCE
- TRANSPARENCY
- COMMITMENT
- AUTHENTIC

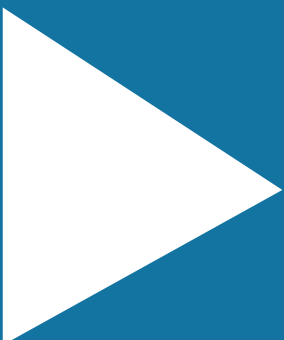

INDUSTRIES / SECTOR WE SERVE



Education Sector



Steel and Metal Industries

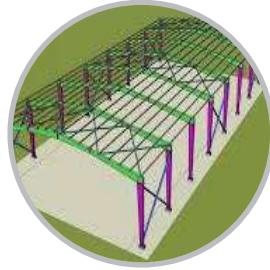

Pre – Engineered Buildings



Manufacturing Industries



Structural Steel Works



Infrastructure

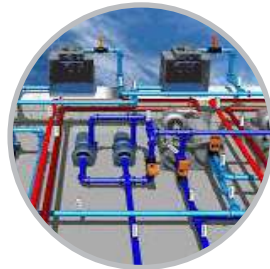

MEP



Metro / Defence



Food Industries



Pharma / Hospital Companies



Steel Building



Warehouses & Cold Storages

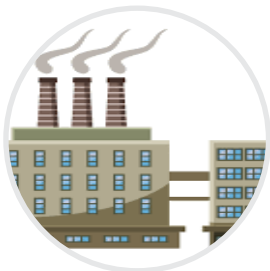

Chemical Industries



FMCG Companies



Industrial Building



Fishing Industries

STRENGTHS OF SISPL

Primary Section

- ▶ Plasma Machine - Bed Size: 4.5m x 30m
- ▶ H-Beam Welding Line - Pull Through Welding (PTW)
- ▶ Hydraulic Press - 100tons
- ▶ Hydraulic Shearing Machine - upto 16mm
- ▶ 30+ CO2/MIG Welding Machines
- ▶ 20+ Advanced Broach Cutters
- ▶ Dedicated Blasting Booth: Sand/Shot Blasting
- ▶ Dedicated Covered Paint Booth

Secondary Section

- ▶ Trapezoidal Coated Sheet Profile Machine
- ▶ Cee/Zee Profile Purlin Machine
- ▶ Standing Seam Profile Machine
- ▶ GI Angle Roll Forming Machine
- ▶ Sheet Crimping Machine
- ▶ Gutter Profile Machine
- ▶ Down-take Profile Machine
- ▶ Slitting cum CTL Machine
- ▶ 4mtr Folding Machine/Bending Machine
- ▶ Foundation Bolts: Band Saw/Threading/Bending Machine

YEAR ON YEAR GROWTH

Value in Crores

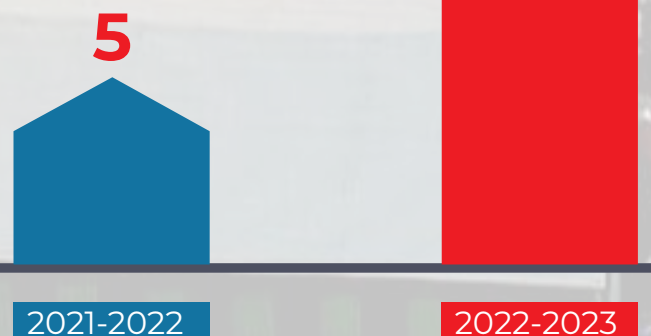

Infrastructure

- ▶ Well Equipped Manufacturing Facility: 100000+ Sq ft
- ▶ MSEB Power of 250 Kva Transformer and 125 Kva Diesel Generator
- ▶ 7.5 MT EOT Cranes for Material handlings: 05 Nos
- ▶ 14ton Hydra-Crane for Internal Material Handlings: 02 Nos
- ▶ 2000 tons+Raw Material Dedicated Storage Space
- ▶ In-house 100 tons Weight Bridge
- ▶ Manufacturing Facility Staff / Labors: 150+
- ▶ Erection Staff/Engineers: 15 Nos / 250+ Manpower
- ▶ Corporate Office Facility At Pimpri , Pune - 20+Professionals
- ▶ Inhouse Transport Facility

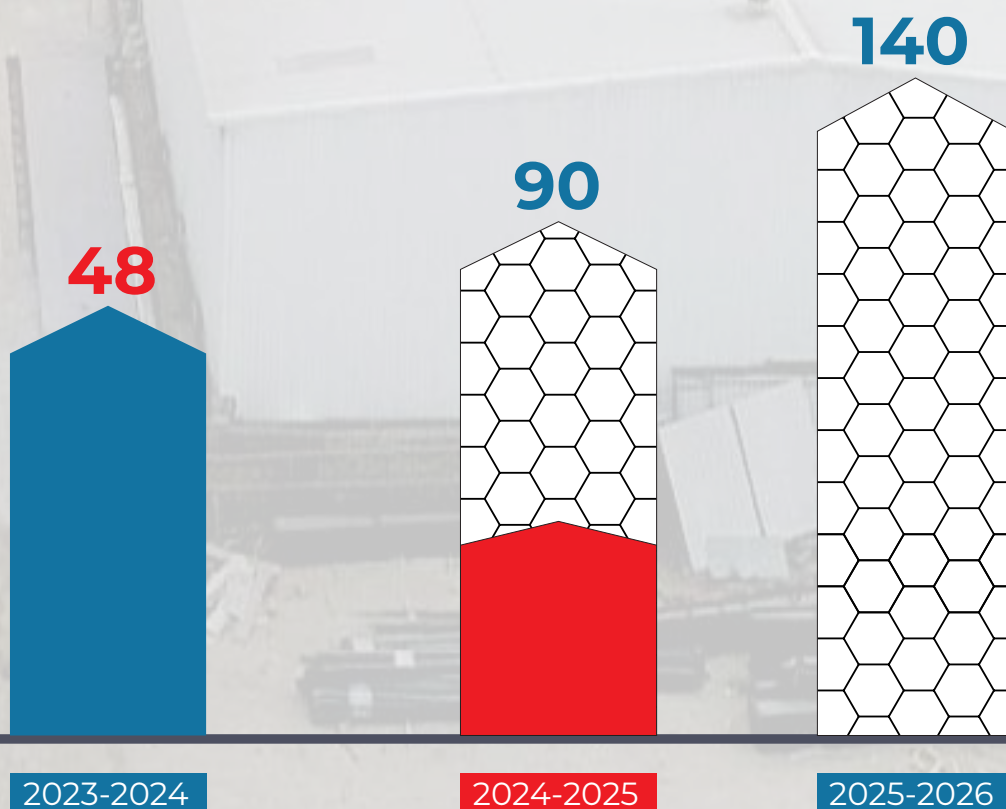

LIST OF MACHINERY

Primary Section



Plasma Machine



H-Beam Welding



Hydraulic Press



Hyd. Shearing Machine



Dedicated Blasting Booth



Dedicated Covered Paint Booth



CO2/MIG Welding Machine



Advanced Broach Cutter

Secondary Section



Coated Sheet Profile Machine



Cee/Zee Profile Purlin Machine



Standing Seam Profile Machine

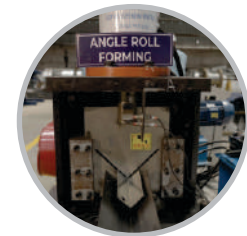

GI Angle Roll Forming Machine



Crimping Machine



Gutter Profile Machine



Down-take Profile Machine



Slitting cum CTL Machine



4mtr Folding Machine/Bending Machine

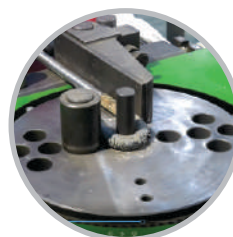

Band Saw/Threading/Bending Machine

GLIMPSE OF THE FACILITY



**MANUFACTURING
UNIT BIRDS EYE VIEW**

GLIMPSE OF THE FACILITY



Primary Section

GLIMPSE OF THE FACILITY

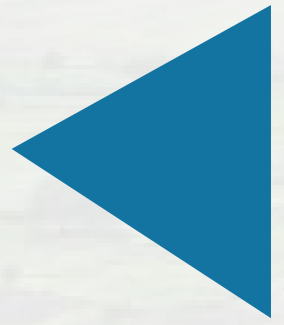

Secondary Section

PEB Options

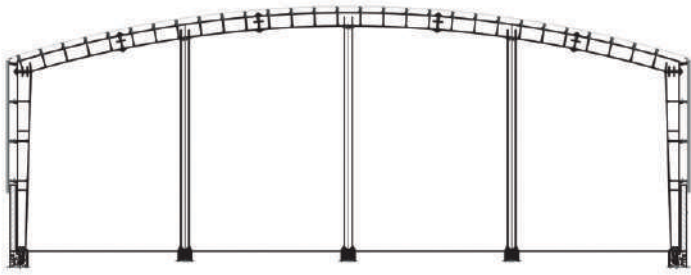

4 - SPAN WITH CURVED ROOF

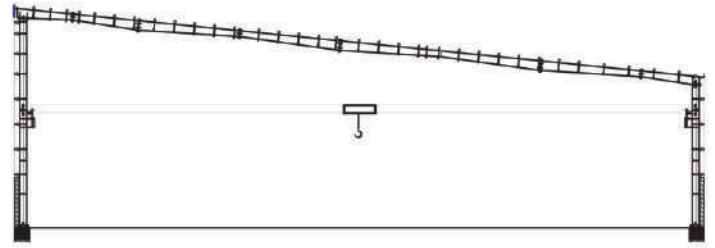

CLEAR SPAN MONOSLOPE FRAME

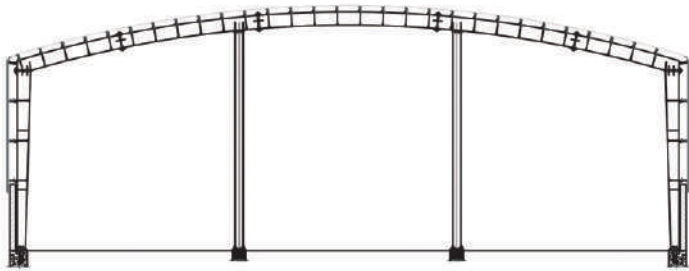

3- SPAN WITH CURVED ROOF

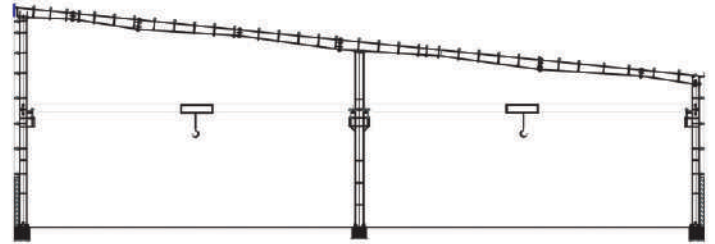

MULTI SPAN MONOSLOPE FRAME

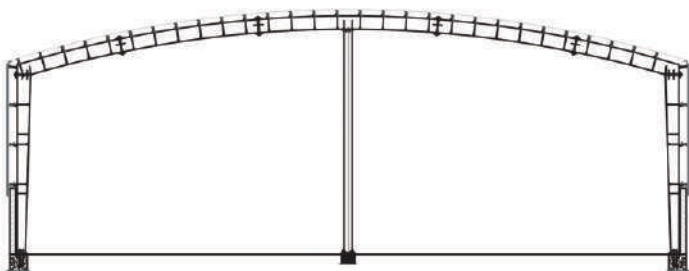

2- SPAN WITH CURVED ROOF

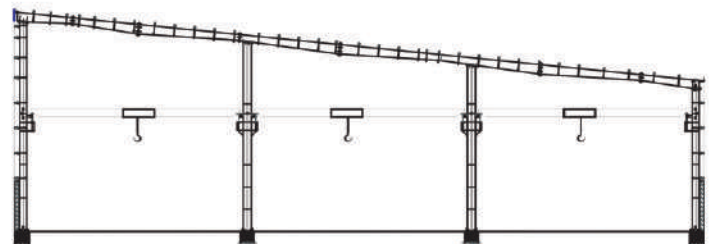

MULTI SPAN MONOSLOPE FRAME

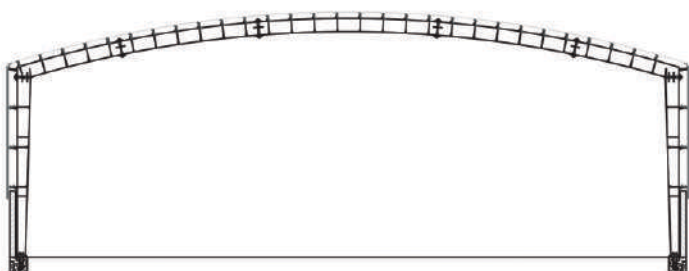

TYPICAL FRAME FOR CURVED ROOF

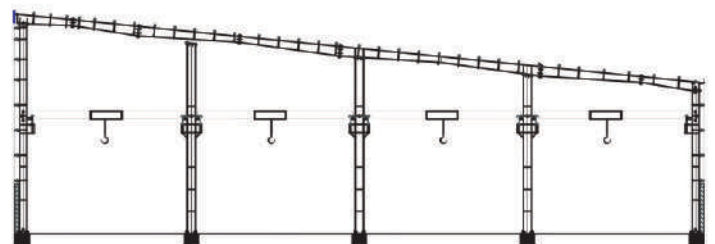

MULTI SPAN MONOSLOPE FRAME

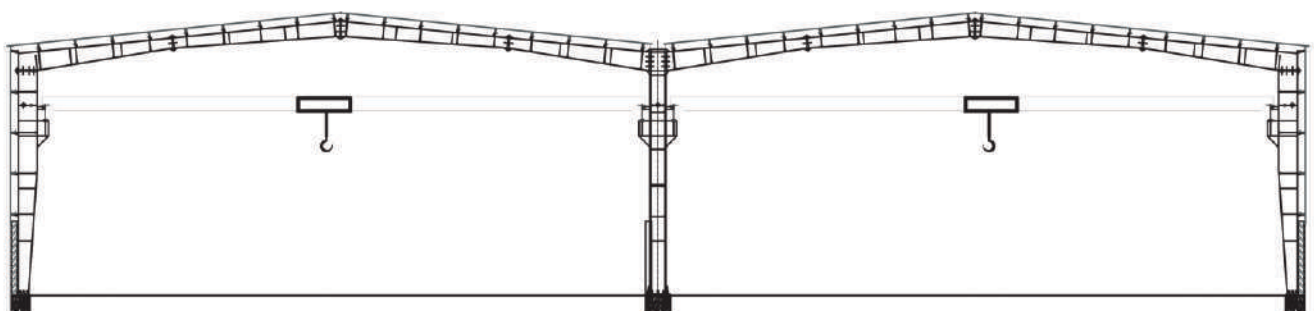

MULTI GABLE FRAME

PEB Options

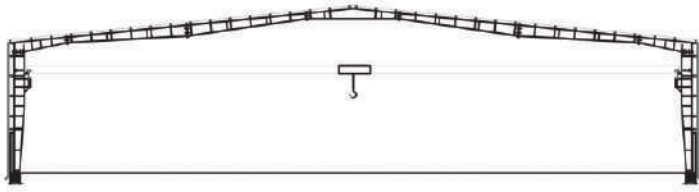

CLEAR SPAN WITH CRANE

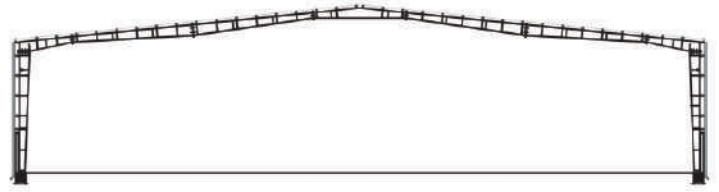

CLEAR SPAN WITHOUT CRANE

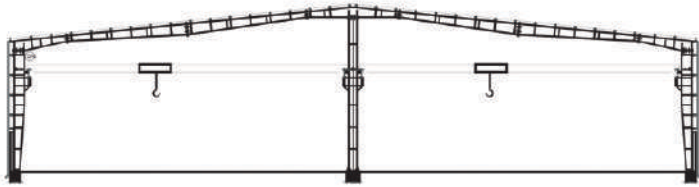

MULTI SPAN FRAME WITH CRANE



MULTI SPAN FRAME WITHOUT CRANE

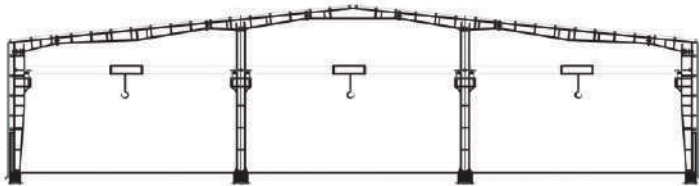

MULTI SPAN FRAME WITH CRANE

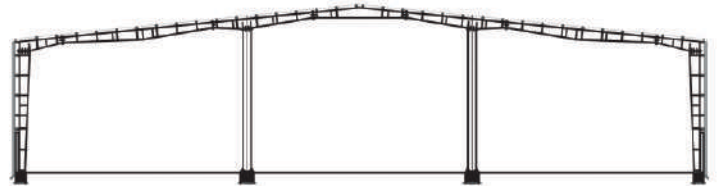

MULTI SPAN FRAME WITHOUT CRANE

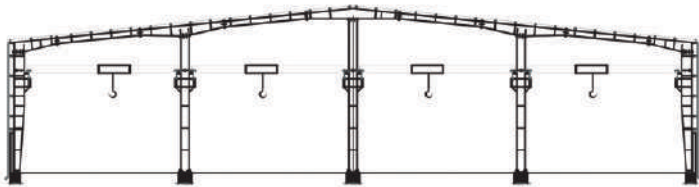

MULTI SPAN FRAME WITH CRANE



MULTI SPAN FRAME WITHOUT CRANE

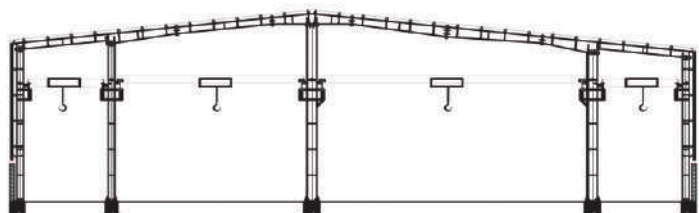

MULTI SPAN FRAME WITH LEAN TO STRUCTURE
MULTI SPAN FRAME WITH CRANE

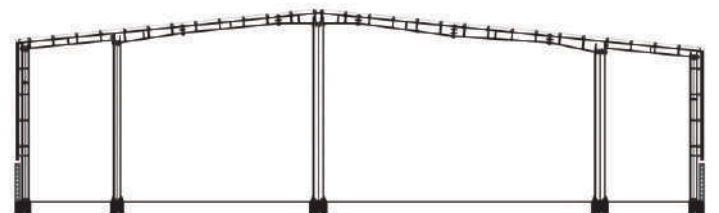

MULTI SPAN FRAME WITH LEAN TO STRUCTURE

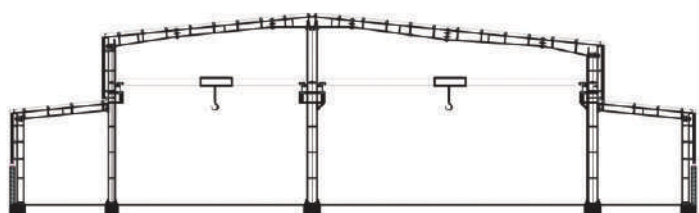

MULTI SPAN FRAME WITH LEAN TO STRUCTURE
MULTI SPAN FRAME WITH CRANE

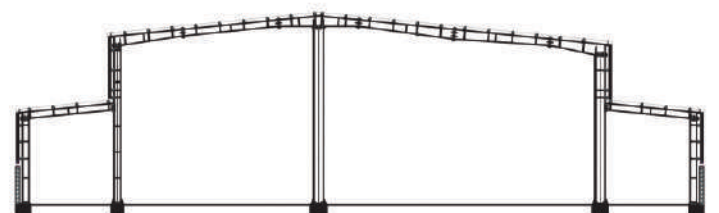

MULTI SPAN FRAME WITH LEAN TO STRUCTURE

EXECUTED PROJECTS



AEROEAGLE AUTOMOBILES | 3.70cr | 70,000 Sq.Ft | Chakan, Pune



HWASHIN AUTOMOTIVE | 4.50cr | 86,000 Sq.Ft | Talegoan, Pune

EXECUTED PROJECTS



Motherson | 8.00cr | 95,000 Sq.Ft | Chakan, Pune



Sellowrap Industries | 3.80cr | 60,000 Sq.Ft | Chakan, Pune

EXECUTED PROJECTS



Amul Milk Products | 2.50cr | 70,000 Sq.Ft | Koregoan Bhima, Pune



Pyrotek India | 5.00cr | 60,000 Sq.Ft | Sanaswadi, Pune

EXECUTED PROJECTS



Jindal Steel Works | 10.00cr | 150,000 Sq.Ft | Sanaswadi, Pune



ATA Impex | 4.00cr | 92,000 Sq.Ft | Sanaswadi, Pune

EXECUTED PROJECTS



Asahi Glass | 8.00cr | 150,000 Sq.Ft | Chakan, Pune



Teconnex | 4.00cr | 77,250 Sq.Ft | Chakan, Pune

EXECUTED PROJECTS



SANY Heavy | 7.50cr | 220,000 Sq.Ft | Chakan, Pune



SAR Logistics | 12.00cr | 288,500 Sq.Ft | Talegaon, Pune

EXECUTED PROJECTS



EPIQ-ADF | 4.20cr | 96,000 Sq.Ft | Moi, Pune



EPIQ-ADF | 1.80cr | 46,000 Sq.Ft | Moi, Pune

EXECUTED PROJECTS



Faith Automation | 4.00cr | 104,180 Sq.Ft | Chakan, Pune



LUMAX INDUSTRIES | 12.00cr | 270,000 Sq.Ft | Chakan, Pune

EXECUTED PROJECTS



Grupo Antoline | 1.60Cr | 70000 Sq.Ft | Chakan, Pune



Silver Bright | 2.40 Cr | 60000 Sq.Ft | Chakan, Pune

CLIENTELE



Mr. Nilesh Tipre

Director

+91 7304 69 4331

nilesh.tipre@sovereignsteels.com

sales@sovereignsteels.com

www.sovereignsteels.com

Office No. 1, 2nd Floor, BIZHUB Condominium,
Pimpri Chowk, Pimpri, Pune-411018,

